



City of Westminster

Licensing Sub-Committee Report

Item No:

Date:

Licensing Ref No:

Title of Report:

Report of:

Wards involved:

Policy context:

Financial summary:

Report Author:

Contact details

20 July 2022

22/03481/LIPV - Premises Licence Variation

W H Smith
Paddington Station
Praed Street
London
W2 1HB

Director of Public Protection and Licensing

Hyde Park

City of Westminster Statement of Licensing Policy

None

Kevin Jackaman
Senior Licensing Officer

Telephone: 0207 641 6500
Email: kjackaman@westminster.gov.uk

1.	Application		
1-A	Applicant and premises		
Application Type:	Variation of a Premises Licence, Licensing Act 2003		
Application received date:	30 March 2022		
Applicant:	Wh Smith Travel Holdings Limited		
Premises:	W H Smith		
Premises address:	Paddington Station Praed Street London W2 1HB	Ward:	Hyde Park
		Cumulative Impact Area:	None
		Special Consideration Zone:	None
Premises description:	The premises are a WH Smith Retail Unit inside London Paddington Station.		
Variation description:	<p>To replace condition 15 at Annex 2 which reads as follows “There shall be no self-service of spirits on the premises, save for spirit mixers of less than 5.5% ABV” so that it reads as follows: “Save for spirit mixers, there shall be no self service of spirits on the premises”</p> <p>To vary the opening hours as follows Monday to Friday 05:30 to 22:30 (currently 06:30 to 21:00) Saturday 06:00 to 22:30 (currently 08:00 to 19:00) Sunday 07:00 to 22:30 (currently 08:00 to 19:00)</p> <p>To vary the hours for the sale of alcohol Monday to Friday 08:00 to 22:30 (currently 08:00 to 21:00) Saturday 08:00 to 22:30 (currently 08:00 to 19:00) Sunday 09:00 to 22:30 (currently 09:00 to 19:00)</p>		
Premises licence history:	<p>The premises has had the benefit of a premises licence since February 2021. The current premises licence reference is 21/01315/LIPDPS, a copy of which is attached as Appendix 1 of this report.</p> <p>Please see Appendix 4 of the report for a full licence history</p>		
Applicant submissions:	<p>Following the submission of the representation from the Metropolitan Police Service, the applicant has contacted the Police advising of the following in respect of the Removal of ABV restriction on spirit mixers:-</p> <p>“An application was submitted by the applicant to remove a similar condition for their premises at Victoria Station. This was granted in the absence of any representations.</p> <p>The applicant is simply seeking to make the same adjustment to the licences for Marylebone and Paddington to bring these sites in line with not only Victoria but their other premises across the capital (and further afield) where we have made a</p>		

	<p>succession of applications to remove the same condition. All have been granted thus far and those premises where the restriction has been removed continue to operate without issue.</p> <p>The applicant offers a very limited range of alcohol (including a small range of spirit mixers) within their premises (the premises licences for Paddington and Marylebone both restrict the sales area for alcohol to no more than 15% of the total sales area in the premises and each licence is subject to, amongst other things, a condition restricting sales of super strength beers, lagers and ciders). Save for spirit mixers all other spirits will continue to be offered for sale form behind the counter”</p>
Applicant amendments:	None

1-B	Current and proposed licensable activities, areas and hours					
Sale by Retail of Alcohol						
On or off sales			Current :		Proposed:	
			Off		No change	
	Current Hours		Proposed Hours		Licensable Area	
	Start:	End:	Start:	End:	Current:	Proposed:
Monday	08:00	21:00	08:00	22:30	Retail unit	No change
Tuesday	08:00	21:00	08:00	22:30		
Wednesday	08:00	21:00	08:00	22:30		
Thursday	08:00	21:00	08:00	22:30		
Friday	08:00	21:00	08:00	22:30		
Saturday	08:00	19:00	08:00	22:30		
Sunday	09:00	19:00	09:00	22:30		
Seasonal variations/ Non-standard timings:		Current:			Proposed:	
		None			No change	

Hours premises are open to the public						
	Current Hours		Proposed Hours		Premises Area	
	Start:	End:	Start:	End:	Current:	Proposed:
Monday	06:30	21:00	05:30	22:30	Retail unit	No change
Tuesday	06:30	21:00	05:30	22:30		
Wednesday	06:30	21:00	05:30	22:30		
Thursday	06:30	21:00	05:30	22:30		
Friday	06:30	21:00	05:30	22:30		
Saturday	08:00	19:00	06:00	22:30		
Sunday	08:00	19:00	07:00	22:30		
Seasonal variations/ Non-standard timings:		Current:			Proposed:	
		None			No change	

1-C	Layout alteration
------------	--------------------------

No change of layout is proposed

1-D	Conditions being varied, added or removed	
Condition 15	Proposed variation	
There shall be no self-service of spirits on the premises, save for spirit mixers of less than 5.5% ABV	Save for spirit mixers, there shall be no self service of spirits on the premises”	
Adult entertainment:	Current position:	Proposed position:
	None	No change

2.	Representations	
2-A	Responsible Authorities	
Responsible Authority:	Metropolitan Police Service	
Representative:	Reaz Guerra	
Received:	05 April 2022	
<p>With reference to the above applications, I am writing to inform you that the Metropolitan Police, as a Responsible Authority, are objecting to this application as it is our belief that if granted the application would undermine the Prevention of Crime and Protection of Children from Harm licensing objectives.</p> <p>There is insufficient detail contained within the operating schedule to promote the licensing objectives.</p> <p>It is for these reasons that we object to this application.</p>		

3.	Policy & Guidance	
The following policies within the City Of Westminster Statement of Licensing Policy apply:		
Policy HSR1 applies	<p>A. Applications within the core hours set out below in this policy will generally be granted for the relevant premises uses, subject to not being contrary to other policies in the Statement of Licensing Policy.</p> <p>B. Applications for hours outside the core hours set out in Clause C will be considered on their merits, subject to other relevant policies, and with particular regard to the following:</p> <ol style="list-style-type: none"> 1. The demonstration of compliance in the requirements of policies CD1, PS1, PN1 and CH1 associated with the likelihood of the effect of the grant of a licence for later or earlier hours on crime and disorder, public safety, public nuisance and the protection of children from harm. 2. If the application is located within a Special Consideration Zone they have demonstrated that they have taken account of the issues identified in that area and provided adequate mitigation. 3. Whether there is residential accommodation in the proximity of the premises that would likely be adversely affected by premises being open or carrying out operations at the hours proposed. 	

	<p>4. The proposed hours of the licensable activities and when customers will be permitted to remain on the premises.</p> <p>5. The proposed hours when any music, including incidental music, will be played.</p> <p>6. The hours when customers will be allowed to take food or drink outside the premises or be within open areas which form part of the premises.</p> <p>7. The existing hours of licensable activities and the past operation of the premises (if any) and hours of licensable premises in the vicinity.</p> <p>8. Whether customers and staff have adequate access to public transport when arriving at and leaving the premises, especially at night.</p> <p>9. The capacity of the premises.</p> <p>10. The type of use, recognising that some venues are more likely to impact the licensing objectives than others; for example, pubs and bars are higher risk than theatres, cinemas and other cultural and sporting venues due to the nature of the operation.</p> <p>11. The Licensing Authority will take into account the active measures proposed for a 'winding down' period including arrangements for people to be collected from the premises to travel home safely.</p> <p>12. Conditions on hours may be attached that require that the supply of alcohol for consumption on the premises ceases a suitable period of time before customers are required to leave the premises.</p> <p>13. The council, acting as the Licensing Authority, may reduce hours if, after review, it is necessary to impose conditions specifying shorter hours in order to promote the licensing objectives.</p> <p>14. Specific days for non-standard hours should be identified and justified as part of the application to allow responsible authorities and interested parties to evaluate the impact that these licensable activities may have, and to plan accordingly. The consideration of applications for later hours for Bank Holiday Mondays will take into account that later hours are generally granted for preceding Sundays and that the next day is a working day. Non-specific days are expected to be covered by Temporary Event Notices or variation applications.</p> <p>C. For the purpose of Clauses A and B above, the Core Hours for applications for each premises use type as defined within this policy are:</p> <p>10a. Shops (all licensable activities that are provided as ancillary to the primary use of the premises as a shop except the off sale of alcohol) Monday to Thursday: 9am to 11.30pm. Friday and Saturday: 9am to Midnight. Sunday: 9am to 10.30pm. Sundays immediately prior to a bank holiday: 9am to Midnight. 10b. Shops (off-sales of alcohol where it forms either the ancillary or primary use of the premises) Monday to Saturday: 8am to 11pm. Sunday: 9am to 10.30pm.</p> <p>D. Core hours are when customers are permitted to be on the premises and therefore the maximum opening hours permitted will be to the same start and terminal hours for each of the days where licensable activity is permitted.</p> <p>E. For the purposes of this policy, 'premises uses' are defined within the relevant premises use policies within this statement.</p>
Policy SHP1(A) applies	A. Applications for a shop outside the West End Cumulative Impact Zone will generally be granted subject to:

	<ol style="list-style-type: none"> 1. The application meeting the requirements of policies CD1, PS1, PN1 and CH1. 2. The hours for licensable activities are within the council's Core Hours Policy HRS1. 3. The operation of any delivery services for alcohol meeting the council's Ancillary Alcohol and/or Latenight Refreshment Delivery Service Policy DEL1. 4. The applicant having taken account of the Special Consideration Zone Policy SCZ1 if the premises are located within a designated zone. 5. The application and operation of the venue meeting the definition of a shop in Clause C. <p>C. For the purposes of this policy:</p> <ol style="list-style-type: none"> 1. A shop is defined as a stall, vehicle, vessel, temporary structure, building or part of a stall, vehicle, vessel, temporary structure or building where the primary activity is the sale of goods or services to customers upon payment. 2. The licensable activities for the sale of alcohol for consumption on the premises, regulated entertainment and/or late night refreshment must be ancillary to the primary use of the premises as a shop. 3. The licensable activity of the sale of alcohol for consumption off the premises must be an ancillary function to the primary use of the premises unless that primary use is to sell alcohol for consumption off the premises, e.g. a traditional off licence.
--	---

4. Equality Implications

The Council in its capacity as Licensing Authority has a duty to have regard to its public sector equality duty under section 149 of the Equality Act 2010. In summary, section 149 provides that a Public Authority must, in the exercise of its functions, have due regard to the need to:

- (a) eliminate discrimination harassment, victimisation and any other conduct that is prohibited by or under this Act;
- (b) advance equality of opportunity between persons who share a relevant protected characteristic and persons who do not share it; and
- (c) foster good relations between persons who share a relevant protected characteristics and persons who do not share it.

Section 149 (7) of the Equality Act 2010 defines the relevant protected characteristics as age, disability, gender reassignment, marriage and civil partnership, pregnancy and maternity, race, religion or belief, sex, and sexual orientation.

5.	Appendices
Appendix 1	Premises Licence 21/01315/LIPDPS
Appendix 2	Applicant supporting documents
Appendix 3	Premises history
Appendix 4	Proposed conditions
Appendix 5	Residential map and list of premises in the vicinity

Report author:	Kevin Jackaman Senior Licensing Officer
Contact:	Telephone: 0207 641 6500 Email: kjackaman@westminster.gov.uk

If you have any queries about this report or wish to inspect one of the background papers please contact the report author.

Background Documents – Local Government (Access to Information) Act 1972

1	Licensing Act 2003	N/A
2	City of Westminster Statement of Licensing Policy	7 th January 2021
3	Amended Guidance issued under section 182 of the Licensing Act 2003	April 2018
4	Metropolitan Police Service representation	05 April 2022



City of Westminster
64 Victoria Street, London, SW1E 6QP

Schedule 12
Part A

WARD: Hyde Park
UPRN: 100023477448

Premises licence

Regulation 33, 34

Premises licence number:

21/01315/LIPDPS

Original Reference:

21/00258/LIPN

Part 1 – Premises details

Postal address of premises:

W H Smith
Paddington Station
Praed Street
London
W2 1HB

Telephone Number: Not supplied

Where the licence is time limited, the dates:

Not applicable

Licensable activities authorised by the licence:

Sale by Retail of Alcohol

The times the licence authorises the carrying out of licensable activities:

Sale by Retail of Alcohol

Monday to Friday:	08:00 to 21:00
Saturday:	08:00 to 19:00
Sunday:	09:00 to 19:00

The opening hours of the premises:

Monday to Friday:	06:30 to 21:00
Saturday to Sunday:	08:00 to 19:00

Where the licence authorises supplies of alcohol, whether these are on and/or off supplies:

Alcohol is supplied for consumption off the Premises.

Part 2

Name, (registered) address, telephone number and email (where relevant) of holder of premises licence:

Wh Smith Travel Holdings Limited
Greenbridge Road
Swindon
Wiltshire
SN3 3RX

Registered number of holder, for example company number, charity number (where applicable)

05681969

Name, address and telephone number of designated premises supervisor where the premises licence authorises the supply of alcohol:

Name: Mr Rizwan Madhizai

Please note: It is the policy of the Licensing Authority not to display the address details of a designated premises supervisor.

Personal licence number and issuing authority of personal licence held by designated premises supervisor where the premises licence authorises for the supply of alcohol:

Licence Number: PER/2021/0005
Licensing Authority: London Borough Of Hackney

Date: 16 March 2021

This licence has been authorised by Ola Ajose-Adeogun on behalf of the Director - Public Protection and Licensing.

Annex 1 – Mandatory conditions

1. No supply of alcohol may be made at a time when there is no designated premises supervisor in respect of this licence.
2. No supply of alcohol may be made at a time when the designated premises supervisor does not hold a personal licence or the personal licence is suspended.
3. Every supply of alcohol under this licence must be made or authorised by a person who holds a personal licence.
4.
 - (1) The responsible person must ensure that staff on relevant premises do not carry out, arrange or participate in any irresponsible promotions in relation to the premises.
 - (2) In this paragraph, an irresponsible promotion means any one or more of the following activities, or substantially similar activities, carried on for the purpose of encouraging the sale or supply of alcohol for consumption on the premises—
 - (a) games or other activities which require or encourage, or are designed to require or encourage, individuals to;
 - (i) drink a quantity of alcohol within a time limit (other than to drink alcohol sold or supplied on the premises before the cessation of the period in which the responsible person is authorised to sell or supply alcohol), or
 - (ii) drink as much alcohol as possible (whether within a time limit or otherwise);
 - (b) provision of unlimited or unspecified quantities of alcohol free or for a fixed or discounted fee to the public or to a group defined by a particular characteristic in a manner which carries a significant risk of undermining a licensing objective;
 - (c) provision of free or discounted alcohol or any other thing as a prize to encourage or reward the purchase and consumption of alcohol over a period of 24 hours or less in a manner which carries a significant risk of undermining a licensing objective;
 - (d) selling or supplying alcohol in association with promotional posters or flyers on, or in the vicinity of, the premises which can reasonably be considered to condone, encourage or glamorise anti-social behaviour or to refer to the effects of drunkenness in any favourable manner;
 - (e) dispensing alcohol directly by one person into the mouth of another (other than where that other person is unable to drink without assistance by reason of a disability).
5. The responsible person must ensure that free potable water is provided on request to customers where it is reasonably available.
6.
 - (1) The premises licence holder or club premises certificate holder must ensure that an age verification policy is adopted in respect of the premises in relation to the sale or supply of alcohol.
 - (2) The designated premises supervisor in relation to the premises licence must ensure that the supply of alcohol at the premises is carried on in accordance with the age verification policy.

- (3) The policy must require individuals who appear to the responsible person to be under 18 years of age (or such older age as may be specified in the policy) to produce on request, before being served alcohol, identification bearing their photograph, date of birth and either—
 - (a) a holographic mark, or
 - (b) an ultraviolet feature.

7. The responsible person must ensure that—

- (a) where any of the following alcoholic drinks is sold or supplied for consumption on the premises (other than alcoholic drinks sold or supplied having been made up in advance ready for sale or supply in a securely closed container) it is available to customers in the following measures—
 - (i) beer or cider: ½ pint;
 - (ii) gin, rum, vodka or whisky: 25 ml or 35 ml; and
 - (iii) still wine in a glass: 125 ml;
- (b) these measures are displayed in a menu, price list or other printed material which is available to customers on the premises; and
- (c) where a customer does not in relation to a sale of alcohol specify the quantity of alcohol to be sold, the customer is made aware that these measures are available.

A responsible person in relation to a licensed premises means the holder of the premise licence in respect of the premises, the designated premises supervisor (if any) or any individual aged 18 or over who is authorised by either the licence holder or designated premises supervisor. For premises with a club premises certificate, any member or officer of the club present on the premises in a capacity that which enables him to prevent the supply of alcohol.

8(i) A relevant person shall ensure that no alcohol is sold or supplied for consumption on or off the premises for a price which is less than the permitted price.

8(ii) For the purposes of the condition set out in paragraph 8(i) above -

- (a) "duty" is to be construed in accordance with the Alcoholic Liquor Duties Act 1979;
- (b) "permitted price" is the price found by applying the formula -

$$P = D + (D \times V)$$

Where -

- (i) P is the permitted price,
 - (ii) D is the amount of duty chargeable in relation to the alcohol as if the duty were charged on the date of the sale or supply of the alcohol, and
 - (iii) V is the rate of value added tax chargeable in relation to the alcohol as if the value added tax were charged on the date of the sale or supply of the alcohol;
- (c) "relevant person" means, in relation to premises in respect of which there is in force a premises licence -

- (i) the holder of the premises licence,
 - (ii) the designated premises supervisor (if any) in respect of such a licence, or
 - (iii) the personal licence holder who makes or authorises a supply of alcohol under such a licence;
 - (d) "relevant person" means, in relation to premises in respect of which there is in force a club premises certificate, any member or officer of the club present on the premises in a capacity which enables the member or officer to prevent the supply in question; and
 - (e) "value added tax" means value added tax charged in accordance with the Value Added Tax Act 1994.
- 8(iii). Where the permitted price given by Paragraph 8(ii)(b) above would (apart from this paragraph) not be a whole number of pennies, the price given by that sub-paragraph shall be taken to be the price actually given by that sub-paragraph rounded up to the nearest penny.
- 8(iv). (1) Sub-paragraph 8(iv)(2) below applies where the permitted price given by Paragraph 8(ii)(b) above on a day ("the first day") would be different from the permitted price on the next day ("the second day") as a result of a change to the rate of duty or value added tax.
- (2) The permitted price which would apply on the first day applies to sales or supplies of alcohol which take place before the expiry of the period of 14 days beginning on the second day.

Annex 2 – Conditions consistent with the operating Schedule

9. The licensable activities authorised by this licence and provided at the premises shall be ancillary to the main function of the premises as newsagents/convenience store.
10. Any detail shown on the plan that is not required by the licensing plans regulations is indicative only and subject to change at any time
11. Locations of fire safety equipment and other safety equipment subject to change in accordance with the requirements of the Responsible Authorities or following a risk assessment.
12. The premises shall install and maintain a comprehensive CCTV system as per the minimum requirements of the Westminster Police Licensing Team.
 - (a) All entry and exit points will be covered enabling frontal identification of every person entering in any light condition.
 - (b) The CCTV system shall continually record whilst the premises is open for licensable activities and during all times when customers remain on the premises.
 - (c) All recordings shall be stored for a minimum period of 31 days with date and time stamping.
 - (d) Viewing of recordings shall be made available immediately upon the request of Police or authorised officer throughout the entire 31 day period.
13. No more than 15% of the sales area shall be used at any one time for the sale, exposure for sale or display of alcohol
14. All sales of alcohol for consumption off the premises shall be in sealed containers only, and shall not be consumed on the premises
15. There shall be no self-service of spirits on the premises, save for spirit mixers of less than 5.5% ABV.
16. No super-strength beer, lagers or ciders of 5.5% ABV (alcohol by volume) or above shall be sold at the premises except for premium beers, lagers or ciders, sold in glass bottles.
17. A Challenge 25 proof of age scheme shall be operated at the premises where the only acceptable forms of identification are recognised photographic identification cards, such as a driving licence, passport or proof of age card with the PASS Hologram.
18. All tills shall automatically prompt staff to ask for age verification identification when presented with an alcohol sale
19. A record shall be kept detailing all refused sales of alcohol. The record should include:
 - (a) the date and time of the refused sale and the name of the member of staff who refused the sale.
 - (b) The record shall be available for inspection at the premises by the police or an authorised officer of the City Council at all times whilst the premises is open.

20. Notices shall be prominently displayed at all exits requesting patrons to respect the needs of local residents and businesses and leave the area quietly
21. Measures will be in place for the safe evacuation of persons with disabilities in case of fire or emergency
22. Staff are trained to ensure that in case of any doubt whether a purchaser is over the age of 18 that they must refuse a sale of alcohol unless valid identification is produced.
23. This training shall be refreshed on an annual basis with copies of training records being made available to the relevant officer of the responsible authority, and/or the police, on request
24. All displays of alcohol will be appropriately ticketed to advise purchasers that it is an offence for those under 18 to purchase alcohol.
25. Prominent notices will be displayed at points of sale advising customers that they may be asked to provide evidence of age.
26. Prominent signage indicating the permitted hours for the sale of alcohol shall be displayed so as to be visible before entering the premises, where alcohol is on public display, and at the point of sale.
27. Outside of the hours authorised for the sale of alcohol and whilst the premises are open to the public, the licence holder shall ensure that all alcohol within the premises (including alcohol behind the counter) is secured in a locked store room or behind locked grilles, locked screens or locked cabinet doors so as to prevent access to the alcohol by both customers and staff.
28. No miniature bottles of spirits of 20 cl or below shall be sold from the premises
29. A staff member from the premises who is conversant with the operation of the CCTV system shall be on the premises at all times when the premises is open. This staff member must be able to provide a Police or authorised council officer copies of recent CCTV images or data with the absolute minimum of delay when requested.
30. An incident log shall be kept at the premises, and made available on request to an authorised officer of the City Council or the Police. It must be completed within 24 hours of the incident and will record the following:
 - (a) all crimes reported to the venue
 - (b) all ejections of patrons
 - (c) any complaints received concerning crime and disorder
 - (d) any incidents of disorder
 - (e) all seizures of drugs or offensive weapons
 - (f) any faults in the CCTV system
 - (g) any refusal of the sale of alcohol
 - (h) any visit by a relevant authority or emergency service.

Annex 3 – Conditions attached after a hearing by the licensing authority

None

Annex 4 – Plans

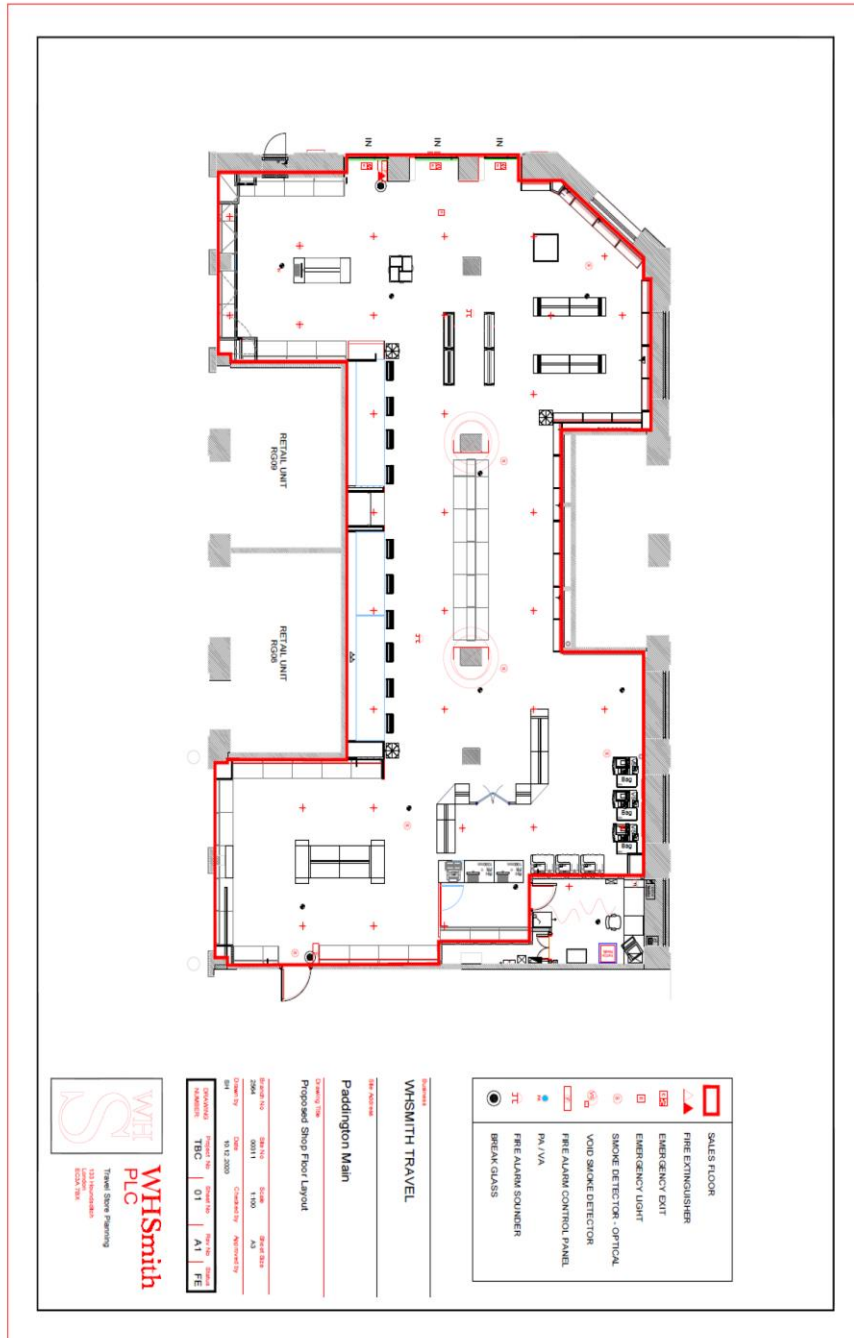



City of Westminster
64 Victoria Street, London, SW1E 6QP

Schedule 12
Part B

WARD: Hyde Park
UPRN: 100023477448

Premises licence
summary

Regulation 33, 34

Premises licence number:

21/01315/LIPDPS

Part 1 – Premises details

Postal address of premises:

W H Smith
Paddington Station
Praed Street
London
W2 1HB

Telephone Number: Not supplied

Where the licence is time limited, the dates:

Not applicable

Licensable activities authorised by the licence:

Sale by Retail of Alcohol

The times the licence authorises the carrying out of licensable activities:

Sale by Retail of Alcohol

Monday to Friday:	08:00 to 21:00
Saturday:	08:00 to 19:00
Sunday:	09:00 to 19:00

The opening hours of the premises:

Monday to Friday:	06:30 to 21:00
Saturday to Sunday:	08:00 to 19:00

Where the licence authorises supplies of alcohol, whether these are on and/or off supplies:

Alcohol is supplied for consumption off the Premises.

Name and (registered) address of holder of premises licence:

Wh Smith Travel Holdings Limited
Greenbridge Road
Swindon
Wiltshire
SN3 3RX

Registered number of holder, for example company number, charity number (where applicable)

05681969

Name of designated premises supervisor where the premises licence authorises for the supply of alcohol:

Name: Mr Rizwan Madhizai

State whether access to the premises by children is restricted or prohibited:

Restricted

Date: 16 March 2021

This licence has been authorised by Ola Ajose-Adeogun on behalf of the Director - Public Protection and Licensing.

In the Matter of an application by WH Smith Travel Holdings Limited

For the Variation of a Premises Licence under the Licensing Act 2003

Case Number - 22/03481/LIPV - W H Smith, Paddington Station

SUBMISSIONS ON BEHALF OF THE APPLICANT

1. These submissions are presented to the Licensing Sub Committee of Westminster City Council in support of an application by WH Smith Travel Holdings Limited (**WHS**) to vary their existing premises licence at their outlet at Paddington Station.
2. The submissions are set out as follows:
 - The Applicant
 - WHS Travel
 - WHS Paddington – Premises licence
 - The Nature of the Application
 - Variation of the Spirit Mixer condition
 - WH Smith Victoria
 - Other premises within Paddington Station
 - Policy considerations
 - Representations
 - Conclusions

The Applicant

3. The Committee will be familiar with the WHS name and style of operation. WHS operates over 1,000 convenience stores in the UK, comprising circa 570 UK Travel units, and over 540 High Street stores. They operate 140 stores in 100 hospitals across the UK. They also operate over 590 International outlets

4. Each of their stores sell a range of products including newspapers, magazines, food and drink, health and beauty products and tech/electrical accessories. Where alcohol licences are held they stock a small range of alcohol. The alcohol range are all recognised household products (WHS do not have their own brand) and as a consequence is priced accordingly.
5. The WHS site operations are supported by a head office team that includes, as one would expect of an organisation of their size, HR, marketing, compliance, health and safety, security, buyers, store operations and management teams to facilitate training and maintenance of licences.
6. All staff receiving training in relation to the sale of alcohol, commensurate with their duties and the stores are covered by CCTV. The designated premises supervisor of the site is of course a personal licence holder.
7. None of their premises licences have ever been the subject of any regulatory enforcement action or subject to a licence review. This is perhaps unsurprising, and does not happen by accident, when one considers the nature of the operator and the nature of the premises.
8. WHS are, on any assessment, an experienced and competent operator who are aware, and conscious, of their obligations as holders of alcohol premises licences.

WHS Travel

9. WHS Travel has sites at a wide range of travel hubs across the country including at airports (29 UK airports) and train stations (over 120 rail locations).
10. In total WHS operate in excess of 40 licensed units at train stations across the country and have been operating licensed outlets at train stations for over 10 years...
11. The WHS offer has adapted over time as the expectations and needs of the traveler have changed. Customers need convenience and have less time to browse. They expect to be able to find the same offer in the travel hub as they might expect on the High Street. As these demands have changed so has the WHS offer providing a one-stop-shop solution.
12. This includes extending opening hours of premises where appropriate and providing the full range of goods that one might reasonable expect to find in a convenience store.
13. Within London, WHS operate licensed sites at the following train stations:
 - Euston
 - Waterloo

- London Bridge
- Kings Cross
- Clapham Junction

14. Within Westminster itself, in addition to Paddington station, WHS operate licensed premises at their sites at Victoria and Marylebone stations

WHS Paddington - Premises Licence

15. The premises licence for WHS Paddington was originally granted in 2012. This licence was subsequently surrendered in March 2018. A further application for a new licence was granted in 2021.

16. On each occasion the licence was granted by way of delegated powers and without the need for a hearing

17. The current licence is already subject to a number of conditions which include, but are not limited to, the following:

- The licensable activities authorised by this licence and provided at the premises shall be ancillary to the main function of the premises as newsagents/convenience store
- The premises shall install and maintain a comprehensive CCTV system as per the minimum requirements of the Westminster Police Licensing Team
 - (a) All entry and exit points will be covered enabling frontal identification of every person entering in any light condition
 - (b) The CCTV system shall continually record whilst the premises is open for licensable activities and during all times when customers remain on the premises.
 - (c) All recordings shall be stored for a minimum period of 31 days with date and time stamping.
 - (d) Viewing of recordings shall be made available immediately upon the request of Police or authorised officer throughout the entire 31 day period.
- No more than 15% of the sales area shall be used at any one time for the sale, exposure for sale or display of alcohol

- No super-strength beer, lagers or ciders of 5.5% ABV (alcohol by volume) or above shall be sold at the premises except for premium beers, lagers or ciders, sold in glass bottles.
- Outside of the hours authorised for the sale of alcohol and whilst the premises are open to the public, the licence holder shall ensure that all alcohol within the premises (including alcohol behind the counter) is secured in a locked store room or behind locked grilles, locked screens or locked cabinet doors so as to prevent access to the alcohol by both customers and staff.
- No miniature bottles of spirits of 20 cl or below shall be sold from the premises.

18. The operation of the premises licences at the application site has never been a cause for regulatory concern.

The Nature of the Application

19. The application for variation is in three parts and is set out below:

- (i) Variation of opening hours
 - Monday to Friday 0530 to 2230 (currently 0630 to 2100)
 - Saturday 0600 to 2230 (currently 0800 to 1900)
 - Sunday 0700 to 2230 (currently 0800 to 1900)
- (ii) Variation of the hours for the sale of alcohol
 - Monday to Friday 0800 to 2230 (currently 0800 to 2100)
 - Saturday 0800 to 2230 (currently 0800 to 1900)
 - Sunday 0900 to 2230 (currently 0900 to 1900)
- (iii) Variation of Conditions

To replace condition 15 at Annex 2 which reads as follows:

“There shall be no self-service of spirits on the premises, save for spirit mixers of less than 5.5% ABV”

so that it reads as follows

“Save for spirit mixers, there shall be no self-service of spirits on the premises”

Variation of the Spirit Mixer condition

20. WHS has, for many years, sold a range of spirit mixer products that include Gin and Tonic and Pimms
21. Over time the range of products being made available to WHS has expanded and now includes pre-packed cans of cocktails which include for example Mojitos, Margaritas and Espresso Martinis.
22. The ABV of these products currently ranges from 6.5% to 14.9%
23. The spirit mixers with an ABV above 5.5% are priced from £3.99 for a 250ml can of gin and tonic mixer, to £4.99 for a 125ml cocktail mixer can.
24. Products of this nature are readily available, for self-service (i.e. not displayed for sale from behind the counter) in other off licence retailers in the Paddington station concourse at a lower price point.
25. At the WHS licensed outlets across the country, where there was no similar spirit mixer condition to that currently attaching to the Paddington licence, WHS has been offering these products for sale since the early part of 2022 with no adverse impact on the licensing objectives.
26. A number of the WHS outlets across the country were subject to a similar condition to that which is found on the Paddington licence. Since the start of the year a series of applications have been made (including within Westminster itself) to vary this condition to enable all spirit mixers to be offered for sale from the shop floor.
27. Each of these applications has been granted (by the relevant licensing authority exercising their delegated authority and without the need for a hearing) and the variation of this condition at other WHS premises has not resulted in any adverse impact on the licensing objectives.
28. There is no reason to believe that, with the addition of these new spirit mixer products, the proposed variation of the condition on the licence at Paddington station will have a detrimental impact on the licensing objectives.

WH Smith Victoria

29. WHS operate a premise at Victoria Station.
30. These premises fall within the Victoria Special Consideration Zone (SCZ1 Statement of Licensing Policy p.59).

31. In February of this year an application to vary the licence was submitted. The nature of the variation application was as follows:

- To vary hours for sale of Alcohol on a Sunday to 0900 to 2230 (currently 1000 to 2230)
- To replace conditions 9 and 16 at Annex 2 which read "There shall be no self-service of spirits on the premises except for spirit mixers below 5.5% Alcohol by Volume" and "There shall be no self-service of spirits on the premises" with the following: "Save for spirit mixers, there shall be no self-service of spirits on the premises"

32. There were no representations to this application from any party (the police having emailed ourselves confirming that "the Metropolitan Police Service **do not** (police emphasis) object to this application"

33. The variation was granted by way of delegated authority and without the need for a hearing.

34. The operation of these premises since the variation has been granted has not had a detrimental impact on the licensing objectives.

Current Premises Licences at Paddington

35. We have carried out an online review of the Westminster City Council Licensing Register of existing off sales operations at Paddington which has revealed the following:

Name of Premises	Station	Opening hours	Hours for sale of alcohol	Condition restricting display of spirit mixers
Sainsbury's	Paddington	24 hours a day on each day of the week	Mon – Sat 0800 to 2300 Sunday 1000 to 2230	No
Marks & Spencer	Paddington	24 hours a day on each day of the week	Mon – Sat 0800 to 2300 Sun 1000 to 2230	No
Whistlestop	Paddington	0600 to 2300 one each day of the week	Mon – Sat 0800 to 2300 Sun 1000 to 2230	No

36. We can find no enforcement activity in relation to any of these premises

37. It is worthy of comment that the opening hours being applied for by WHS are within those currently approved for sites on the Paddington concourse. In addition, the terminal hour for the sale of alcohol on each Monday – Saturday at each of these sites is later than that being applied for by WHS

The Application and Policy Considerations

38. The application site does not sit within the West End Cumulative Impact Zone (CIP1 Statement of Licensing Policy 2021 p.44)

39. The application site does not sit within one of the Licensing Authority's Special Consideration Zone (SCZ1 Statement of Licensing Policy p.53).

40. In so far as the application to vary the opening hours and the hours for the sale of alcohol are concerned, the s.182 National Guidance states (at para 10.15) that *"Shops, stores and supermarkets should normally be free to provide sales of alcohol for consumption off the premises at any times when the retail outlet is open for shopping unless there are good reasons, based on the licensing objectives, for restricting those hours "*

41. WHS has not sought to align the hours for the sale of alcohol with the proposed opening hours, given that the proposed opening hours fall outwith the Council Core Hours Policy (HRS1). Instead, the application for the sale of alcohol is respectful of the Councils Core Hours Policy.

42. The proposed terminal hour for the sale of alcohol falls within the Councils Core Hours Policy as set out at para 10b at p.63 of the Statement of Licensing Policy 2021.

43. The Councils Core Hours Policy (HRS1) states, at p.62, that

"Core Hours Policy HRS1

A. Applications within the core hours set out below in this policy will generally be granted for the relevant premises uses, subject to not being contrary to other policies in the Statement of Licensing Policy."

44. The Councils Licensing Core Hours Policy, at para 10b, on page 63 states as follows:

Shops (off-sales of alcohol where it forms either the ancillary or primary use of the premises)

Monday to Saturday: 8am to 11pm

Sunday: 9am to 10.30pm.

45. When the premises are open outside of the permitted hours for the sale of alcohol, there is an existing condition on the licence that requires

"all alcohol within the premises (including alcohol behind the counter) [to be] secured in a locked store room or behind locked grilles, locked screens or locked cabinet doors so as to prevent access to the alcohol by both customers and staff."

46. In summary, there are no special policy considerations that impact on the application

Representations

47. The sole representation to the application comes from the Police
48. Since receipt of the representation, a succession of emails have been sent to, and we have engaged with, and provided, the Police with further information in relation to the proposed variation.
49. WHS is willing to continue to engage with the Police up to, and at, the hearing of the variation application.

Summary

50. There is only one question of significance here – are these applications, by this applicant, at these premises, likely to undermine the licensing objectives?
51. The National Guidance issued under s.182 of the Licensing Act 2003 states as follows

The Authority's determination should be evidence based, justified as being appropriate for the promotion of the licensing objectives and proportionate to what it is intended to achieve

52. In this case, the application is for variation of an existing permission i.e. the premise is a known quantity. If the licensing authority takes the view that there is not already clear evidence of unacceptable impact from this premise, it may reasonably take the view that the variation sought will not add unacceptably to the impact.

53. As the national guidance states:

“14.36 ... If the licensing authority decides that an application should be refused, it will still need to show that the grant of the application would undermine the promotion of one of the licensing objectives and that appropriate conditions would be ineffective in preventing the problems involved.”

54. The Licensing Sub-Committee can only really make such a finding based on admissible material submitted to it. What the authority cannot be asked to do is speculate, as the High Court make clear in R (Daniel Thwaites) v Wirral Borough Magistrates Court [2008] EWHC 838 (Admin). It can, however, draw fair inferences from the material it does have.

55. It is submitted that, on the evidence presented, the Committee should grant the application because:

- (i) WHS is an experienced and competent operator of licensed premises in some of the busiest travel hubs across the UK
- (ii) Each premise is provided with head office support
- (iii) Their premises sell a wide range of convenience products and experience has shown that these premises will not (and, by virtue of a condition already attaching to the licence) and cannot, be “alcohol led”
- (iv) The existing licence is already subject to a significant schedule of conditions
- (v) The application site has never been subject to regulatory enforcement action
- (vi) The application site has never been subject to a licence review
- (vii) Since the start of the year WHS has made a series of applications to vary the “spirit mixer” condition on their licences in line with the current application. These applications have all been granted without representation
- (viii) The ongoing operation of these licences has had no adverse impact on the licensing objectives

- (ix) A similar application was submitted by WHS for their premises at Victoria which falls within a Special Consideration Zone. This application was granted in the absence of any representations, since when the operation of the licence has not had any adverse impact on the licensing objectives
- (x) The application is for opening hours more restrictive than those currently authorised for other retailers on the Paddington Station concourse
- (xi) The terminal hour for the sale of alcohol is earlier than that currently authorised for other retailers on the Paddington Station concourse
- (xii) The application site does not fall with a CIA
- (xiii) The application site does not fall within a Special Consideration zone
- (xiv) The application to vary the hours for the sale of alcohol is within the Councils Core Hours Policy
- (xv) There are no special policy considerations that impact on the applications

56. In all the circumstances, the granting of this variation, to this applicant, at these premises is unlikely to undermine the licensing objectives, and in the circumstances the variation should be granted as requested.

Ewen Macgregor
Partner
TLT

Dated 7 July 2022

Licence & Appeal History

Application	Details of Application	Date Determined	Decision
21/00258/LIPN	New premises licence	11.02.2021	Granted under delegated authority
21/01315/LIPDPS	Variation of DPS	10.03.2021	Granted under delegated authority

There is no appeal history

CONDITIONS CONSISTENT WITH THE OPERATING SCHEDULE AND CONDITIONS PROPOSED BY A PARTY TO THE HEARING

When determining an application for a new premises licence under the provisions of the Licensing Act 2003, the licensing authority must, unless it decides to reject the application, grant the licence subject to the conditions which are indicated as mandatory in this schedule.

At a hearing the licensing authority may, in addition, and having regard to any representations received, grant the licence subject to such conditions which are consistent with the operating schedule submitted by the applicant as part of their application, or alter or omit these conditions, or add any new condition to such extent as the licensing authority considers appropriate for the promotion of the licensing objectives.

This schedule lists those conditions which are consistent with the operating schedule, or proposed as appropriate for the promotion of the licensing objectives by a responsible authority or an interested party as indicated. These conditions have not been submitted by the licensing service but reflect the positions of the applicant, responsible authority or interested party and have not necessarily been agreed

Conditions: On Current Licence -

Mandatory:

1. No supply of alcohol may be made at a time when there is no designated premises supervisor in respect of this licence.
2. No supply of alcohol may be made at a time when the designated premises supervisor does not hold a personal licence or the personal licence is suspended.
3. Every supply of alcohol under this licence must be made or authorised by a person who holds a personal licence.
4.
 - (1) The responsible person must ensure that staff on relevant premises do not carry out, arrange or participate in any irresponsible promotions in relation to the premises.
 - (2) In this paragraph, an irresponsible promotion means any one or more of the following activities, or substantially similar activities, carried on for the purpose of encouraging the sale or supply of alcohol for consumption on the premises—
 - (a) games or other activities which require or encourage, or are designed to require or encourage, individuals to;
 - (i) drink a quantity of alcohol within a time limit (other than to drink alcohol sold or supplied on the premises before the cessation of the period in which the responsible person is authorised to sell or supply alcohol), or
 - (ii) drink as much alcohol as possible (whether within a time limit or otherwise);
 - (b) provision of unlimited or unspecified quantities of alcohol free or for a fixed or discounted fee to the public or to a group defined by a particular characteristic in a manner which carries a significant risk of undermining a licensing objective;

- (c) provision of free or discounted alcohol or any other thing as a prize to encourage or reward the purchase and consumption of alcohol over a period of 24 hours or less in a manner which carries a significant risk of undermining a licensing objective;
 - (d) selling or supplying alcohol in association with promotional posters or flyers on, or in the vicinity of, the premises which can reasonably be considered to condone, encourage or glamorise anti-social behaviour or to refer to the effects of drunkenness in any favourable manner;
 - (e) dispensing alcohol directly by one person into the mouth of another (other than where that other person is unable to drink without assistance by reason of a disability).
5. The responsible person must ensure that free potable water is provided on request to customers where it is reasonably available.
6. (1) The premises licence holder or club premises certificate holder must ensure that an age verification policy is adopted in respect of the premises in relation to the sale or supply of alcohol.
- (2) The designated premises supervisor in relation to the premises licence must ensure that the supply of alcohol at the premises is carried on in accordance with the age verification policy.
- (3) The policy must require individuals who appear to the responsible person to be under 18 years of age (or such older age as may be specified in the policy) to produce on request, before being served alcohol, identification bearing their photograph, date of birth and either—
- (a) a holographic mark, or
 - (b) an ultraviolet feature.
7. The responsible person must ensure that—
- (a) where any of the following alcoholic drinks is sold or supplied for consumption on the premises (other than alcoholic drinks sold or supplied having been made up in advance ready for sale or supply in a securely closed container) it is available to customers in the following measures—
 - (i) beer or cider: ½ pint;
 - (ii) gin, rum, vodka or whisky: 25 ml or 35 ml; and
 - (iii) still wine in a glass: 125 ml;
 - (b) these measures are displayed in a menu, price list or other printed material which is available to customers on the premises; and
 - (c) where a customer does not in relation to a sale of alcohol specify the quantity of alcohol to be sold, the customer is made aware that these measures are available.

A responsible person in relation to a licensed premises means the holder of the premise licence in respect of the premises, the designated premises supervisor (if any) or any individual aged 18 or over who is authorised by either the licence holder or designated premises supervisor.

For premises with a club premises certificate, any member or officer of the club present on the premises in a capacity that which enables him to prevent the supply of alcohol.

8(i) A relevant person shall ensure that no alcohol is sold or supplied for consumption on or off the premises for a price which is less than the permitted price.

8(ii) For the purposes of the condition set out in paragraph 8(i) above -

(a) "duty" is to be construed in accordance with the Alcoholic Liquor Duties Act 1979;

(b) "permitted price" is the price found by applying the formula -

$$P = D+(D \times V)$$

Where -

(i) P is the permitted price,

(ii) D is the amount of duty chargeable in relation to the alcohol as if the duty were charged on the date of the sale or supply of the alcohol, and

(iii) V is the rate of value added tax chargeable in relation to the alcohol as if the value added tax were charged on the date of the sale or supply of the alcohol;

(c) "relevant person" means, in relation to premises in respect of which there is in force a premises licence -

(i) the holder of the premises licence,

(ii) the designated premises supervisor (if any) in respect of such a licence, or

(iii) the personal licence holder who makes or authorises a supply of alcohol under such a licence;

(d) "relevant person" means, in relation to premises in respect of which there is in force a club premises certificate, any member or officer of the club present on the premises in a capacity which enables the member or officer to prevent the supply in question; and

(e) "value added tax" means value added tax charged in accordance with the Value Added Tax Act 1994.

8(iii). Where the permitted price given by Paragraph 8(ii)(b) above would (apart from this paragraph) not be a whole number of pennies, the price given by that sub-paragraph shall be taken to be the price actually given by that sub-paragraph rounded up to the nearest penny.

8(iv). (1) Sub-paragraph 8(iv)(2) below applies where the permitted price given by Paragraph 8(ii)(b) above on a day ("the first day") would be different from the permitted price on the next day ("the second day") as a result of a change to the rate of duty or value added tax.

(2) The permitted price which would apply on the first day applies to sales or supplies of alcohol which take place before the expiry of the period of 14 days beginning on the second day.

Annex 2 – Conditions consistent with the operating Schedule

9. The licensable activities authorised by this licence and provided at the premises shall be ancillary to the main function of the premises as newsagents/convenience store.
10. Any detail shown on the plan that is not required by the licensing plans regulations is indicative only and subject to change at any time
11. Locations of fire safety equipment and other safety equipment subject to change in accordance with the requirements of the Responsible Authorities or following a risk assessment.
12. The premises shall install and maintain a comprehensive CCTV system as per the minimum requirements of the Westminster Police Licensing Team.
 - (a) All entry and exit points will be covered enabling frontal identification of every person entering in any light condition.
 - (b) The CCTV system shall continually record whilst the premises is open for licensable activities and during all times when customers remain on the premises.
 - (c) All recordings shall be stored for a minimum period of 31 days with date and time stamping.
 - (d) Viewing of recordings shall be made available immediately upon the request of Police or authorised officer throughout the entire 31 day period.
13. No more than 15% of the sales area shall be used at any one time for the sale, exposure for sale of display of alcohol
14. All sales of alcohol for consumption off the premises shall be in sealed containers only, and shall not be consumed on the premises
15. There shall be no self-service of spirits on the premises, save for spirit mixers of less than 5.5% ABV.

The applicant is seeking to vary condition 15 to read as follows:

Save for spirit mixers, there shall be no self service of spirits on the premises

16. No super-strength beer, lagers or ciders of 5.5% ABV (alcohol by volume) or above shall be sold at the premises except for premium beers, lagers or ciders, sold in glass bottles.
17. A Challenge 25 proof of age scheme shall be operated at the premises where the only acceptable forms of identification are recognised photographic identification cards, such as a driving licence, passport or proof of age card with the PASS Hologram.
18. All tills shall automatically prompt staff to ask for age verification identification when presented with an alcohol sale
19. A record shall be kept detailing all refused sales of alcohol. The record should include:
 - (a) the date and time of the refused sale and the name of the member of staff who refused the sale.
 - (b) The record shall be available for inspection at the premises by the police or an authorised officer of the City Council at all times whilst the premises is open.

20. Notices shall be prominently displayed at all exits requesting patrons to respect the needs of local residents and businesses and leave the area quietly
21. Measures will be in place for the safe evacuation of persons with disabilities in case of fire or emergency
22. Staff are trained to ensure that in case of any doubt whether a purchaser is over the age of 18 that they must refuse a sale of alcohol unless valid identification is produced.
23. This training shall be refreshed on an annual basis with copies of training records being made available to the relevant officer of the responsible authority, and/or the police, on request
24. All displays of alcohol will be appropriately ticketed to advise purchasers that it is an offence for those under 18 to purchase alcohol.
25. Prominent notices will be displayed at points of sale advising customers that they may be asked to provide evidence of age.
26. Prominent signage indicating the permitted hours for the sale of alcohol shall be displayed so as to be visible before entering the premises, where alcohol is on public display, and at the point of sale.
27. Outside of the hours authorised for the sale of alcohol and whilst the premises are open to the public, the licence holder shall ensure that all alcohol within the premises (including alcohol behind the counter) is secured in a locked store room or behind locked grilles, locked screens or locked cabinet doors so as to prevent access to the alcohol by both customers and staff.
28. No miniature bottles of spirits of 20 cl or below shall be sold from the premises
29. A staff member from the premises who is conversant with the operation of the CCTV system shall be on the premises at all times when the premises is open. This staff member must be able to provide a Police or authorised council officer copies of recent CCTV images or data with the absolute minimum of delay when requested.
30. An incident log shall be kept at the premises, and made available on request to an authorised officer of the City Council or the Police. It must be completed within 24 hours of the incident and will record the following:
 - (a) all crimes reported to the venue
 - (b) all ejections of patrons
 - (c) any complaints received concerning crime and disorder
 - (d) any incidents of disorder
 - (e) all seizures of drugs or offensive weapons
 - (f) any faults in the CCTV system
 - (g) any refusal of the sale of alcohol
 - (h) any visit by a relevant authority or emergency service.

Annex 3 – Conditions attached after a hearing by the licensing authority

None

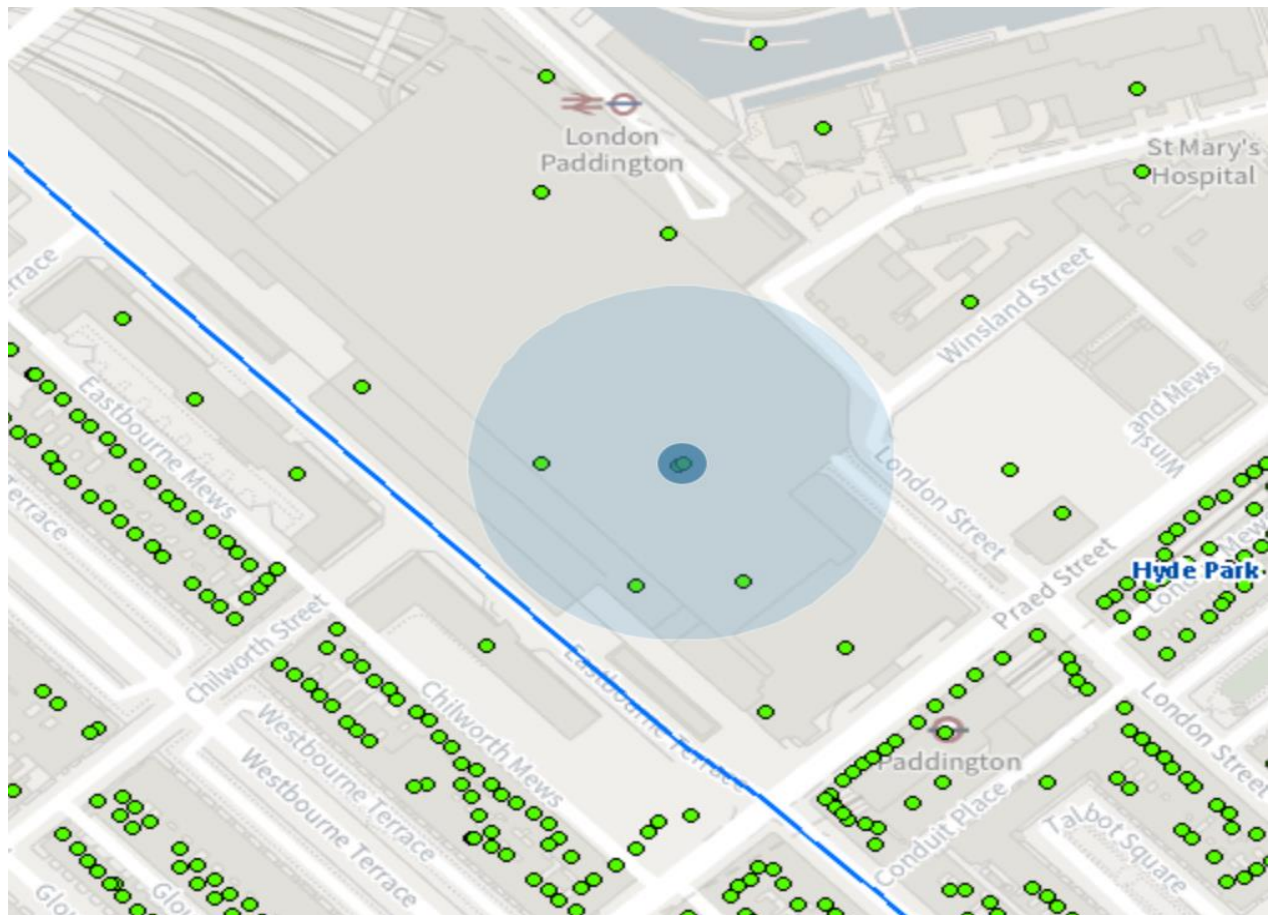

Resident count: 0

Licensed premises with 75m of WH Smith, Paddington Station, Praed Street, London, W2 1HB				
Licence Number	Trading Name	Address	Premises Type	Time Period
20/03898/LIPCH	Delice De France	Unit 19a Paddington Station Praed Street London W2 1HB	Shop	Monday to Sunday; 23:00 - 01:00
21/09318/LIPDPS	Sainsburys	Unit R17 Paddington Station Praed Street London W2 1HB	Shop	Monday to Sunday; 00:00 - 00:00
22/00443/LIPDPS	Mad Bishop & Bear	Unit 32 Paddington Station Praed Street London W2 1HA	Pub or pub restaurant with lodge	Sunday; 07:00 - 23:30 Monday to Saturday; 07:00 - 00:00
08/07361/LIPD	Costa Coffee	Unit R27 Paddington Station Praed Street London W2 1HB	Shop	Monday to Sunday; 00:00 - 00:00
20/05751/LIPCH	Crussh	Unit 41 Paddington Station Praed Street London W2 1HB	Shop	Not Recorded; XXXX - XXXX
13/00723/LIPN	The Savanna	Unit R01 Paddington Station Praed Street	Shop	Monday to Friday; 06:00 -

		London W2 1HB		21:00 Saturday to Sunday; 09:00 - 20:00
21/05062/LIPDPS	The Beer House	Unit R36 Paddington Station Praed Street London W2 1HB	Pub or pub restaurant with lodge	Monday to Sunday; 06:30 - 00:30
13/00246/LIPDPS	WH Smith	Ground Floor Shop Paddington Station Praed Street London W2 1RH	Shop	Monday to Sunday; 07:00 - 22:00
20/03836/LIPCH	Upper Crust	Unit 19 Paddington Station Praed Street London W2 1HB	Takeaway food outlet	Monday to Sunday; 00:00 - 00:00
20/03829/LIPCH	Marks & Spencer - Simply Food	Ground Floor Unit 1 Paddington Station Praed Street London W2 1AE	Shop	Monday; 00:00 - 00:00 Tuesday; 00:00 - 00:00 Wednesday; 00:00 - 00:00 Thursday; 00:00 - 00:00 Friday; 00:00 - 00:00 Saturday; 00:00 - 00:00 Sunday; 00:00 - 00:00
21/05065/LIPDPS	The Cabin	Unit R30 Paddington Station Praed Street London W2 1RH	Public house or pub restaurant	Sunday; 06:30 - 22:50 Monday to Thursday; 06:30 - 23:30 Friday to Saturday; 06:30 - 00:00 Sundays before Bank Holidays; 06:30 - 00:00
21/04679/LIPDPS	Caffe Ritazza	Unit R08 Paddington Station Praed Street London W2 1HB	Cafe	Monday to Sunday; 06:00 - 00:00
22/01333/LIPCH	Caffe Ritazza	Unit R08 Paddington Station Praed Street London W2 1HB	Cafe	Monday to Sunday; 06:00 - 00:00
12/05300/LIPDPS	Searcys Champagne Bar	Unit 58 Paddington Station Praed Street London W2 1HB	Wine bar	Monday to Sunday; 07:30 - 23:00
21/08277/LIPN	Nero Express	Paddington Station Concourse Praed Street London W2 1RH	Cafe	Monday; 00:00 - 00:00 Tuesday; 00:00 - 00:00 Wednesday; 00:00 - 00:00 Thursday; 00:00 - 00:00 Friday; 00:00 - 00:00 Saturday; 00:00 - 00:00 Sunday; 00:00 - 00:00

12/04552/LIPN	Nero Express	Paddington Station Concourse Praed Street London W2 1RH	Kiosk within another property	Monday to Sunday; 00:00 - 00:00
22/01482/LIPCH	Burger King/Caffe Ritazza	Platform 7 And 8 Unit 18 Paddington Station Praed Street London W2 1HB	Takeaway food outlet	Monday to Sunday; 00:00 - 00:00